

NOTES:

1. SUBSTRATE:  
Fused Silica
2. SURFACE S2 TO BE PARALLEL WITH SURFACE S1 TO  $\leq 3$  ARCMIN
3. COATING (APPLY ACROSS CLEAR APERTURE)  
S1: NONE  
  
S2: NONE



ARROW ON EDGE POINTING TOWARDS SURFACE S1



FINE GRIND SURFACE

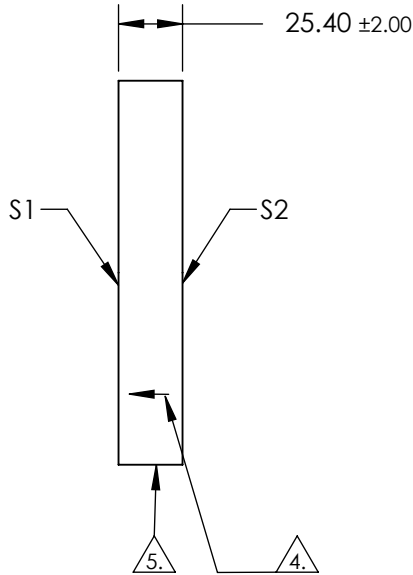
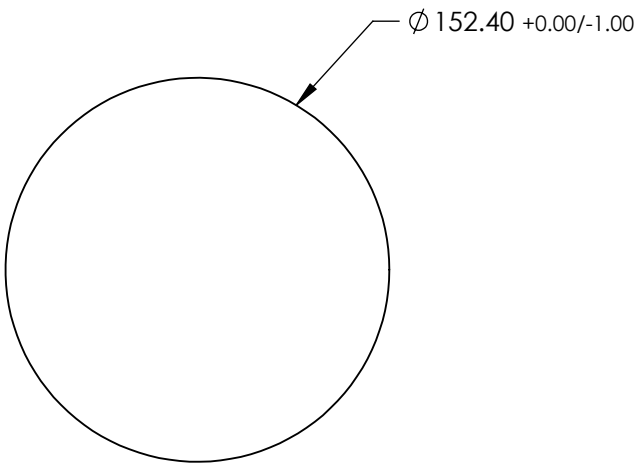

**FOR INFORMATION ONLY: DO NOT  
MANUFACTURE PARTS TO THIS DRAWING**

SPECIFICATIONS SUBJECT TO CHANGE WITHOUT NOTICE  
DIMENSIONS ARE FOR REFERENCE ONLY

	S1	S2
SHAPE	PLANO	PLANO
SURFACE ACCURACY AT 632.8nm	$\lambda/10$	N/A
SURFACE QUALITY	60-40	COMMERCIAL POLISH
CLEAR APERTURE	$\phi 137.20$	$\phi 137.20$
BEVEL	PROTECTED AS NEEDED	PROTECTED AS NEEDED

THIRD ANGLE  
PROJECTION

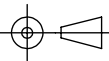

ALL DIMS IN

mm



Edmund Optics®

TITLE

152.4mm Dia.  $\lambda/10$  Fused Silica Optical Flat

DWG NO

01612000

SHEET  
1 OF 1