

NOTES:

1. SUBSTRATE:
Fused Silica
2. SURFACE S2 TO BE PARALLEL WITH SURFACE S1 TO ≤ 3 ARCMIN
3. COATING (APPLY ACROSS CLEAR APERTURE)
S1: NONE

S2: NONE



ARROW ON EDGE POINTING TOWARDS SURFACE S1



FINE GRIND SURFACE

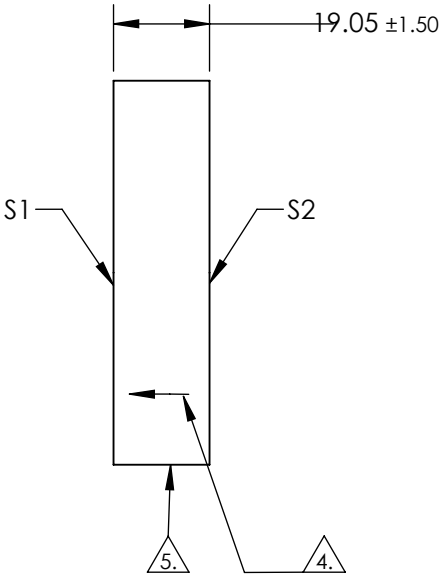
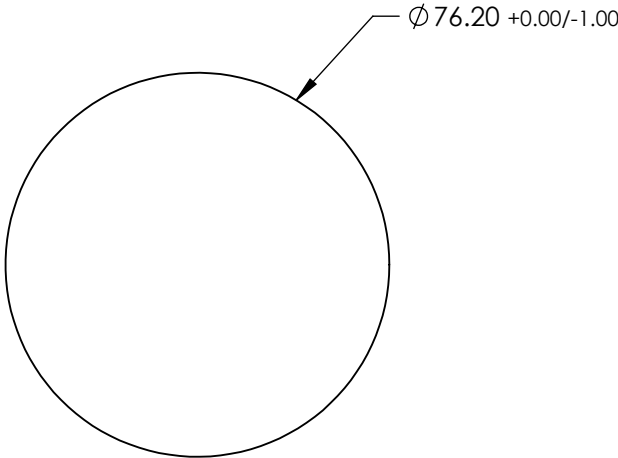

**FOR INFORMATION ONLY: DO NOT
MANUFACTURE PARTS TO THIS DRAWING**

SPECIFICATIONS SUBJECT TO CHANGE WITHOUT NOTICE
DIMENSIONS ARE FOR REFERENCE ONLY

	S1	S2
SHAPE	PLANO	PLANO
SURFACE ACCURACY AT 632.8nm	$\lambda/20$	N/A
SURFACE QUALITY	60-40	COMMERCIAL POLISH
CLEAR APERTURE	$\varnothing 68.60$	$\varnothing 68.60$
BEVEL	PROTECTED AS NEEDED	PROTECTED AS NEEDED

THIRD ANGLE
PROJECTION

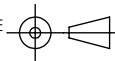

ALL DIMS IN

mm



Edmund Optics®

TITLE

76.2mm Dia. $\lambda/20$ Fused Silica Optical Flat

DWG NO

47573000

SHEET
1 OF 1