

- NOTES:
- 1. SUBSTRATE  
FUSED SILICA
  - 2. ROHS COMPLIANT
  - 3. CENTERING TOLERANCE (AT 587.6nm):  
BEAM DEVIATION (HALF ANGLE): <1 ARCMIN
  - 4. COATING (APPLY ACROSS COATING APERTURE):  
S1 & S2: NONE

5. FINE GRIND SURFACE
- 6. POWER, IRREGULARITY, AND SURFACE QUALITY SPECIFICATIONS  
APPLY ACROSS CLEAR APERTURE
  - 7. FOCAL LENGTH (EFL): 75.00 mm±1%  
BACK FOCAL LENGTH (BFL): 71.96 mm

**FOR INFORMATION ONLY:  
DO NOT MANUFACTURE  
PARTS TO THIS DRAWING**

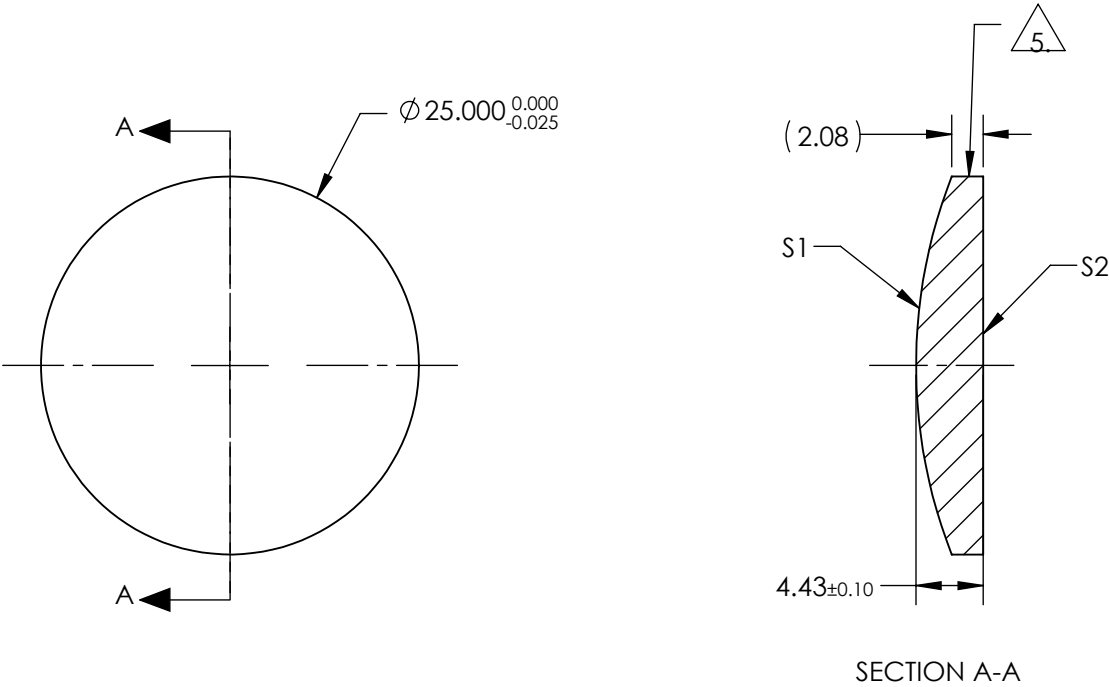

|                        | S1                   | S2                   |
|------------------------|----------------------|----------------------|
| SHAPE                  | CONVEX               | PLANO                |
| RADIUS                 | 34.39                | INFINITY             |
| SURFACE ACCURACY (P-V) | $\lambda/20$         | $\lambda/20$         |
| SURFACE QUALITY        | 20-10                | 20-10                |
| MIN CLEAR APERTURE     | $\varnothing 22.50$  | $\varnothing 22.50$  |
| MIN COATING APERTURE   | N/A                  | N/A                  |
| BEVEL                  | PROTECTIVE AS NEEDED | PROTECTIVE AS NEEDED |

SPECIFICATIONS SUBJECT TO CHANGE WITHOUT NOTICE  
DIMENSIONS ARE FOR REFERENCE ONLY

**Edmund Optics®**

|                           |  |        |  |                 |
|---------------------------|--|--------|--|-----------------|
| THIRD ANGLE<br>PROJECTION |  | TITLE  | 25mm Dia. x 75mm FL Uncoated, $\lambda/20$ PCX<br>Lens |                 |
|                           |  | DWG NO | 33052  | SHEET<br>1 OF 1 |