

NOTES:

- 1. SUBSTRATE MATERIAL: N-BK7
- 2. ONLY ROHS-COMPLIANT MATERIALS ARE ACCEPTABLE.
DO NOT SUBSTITUTE WITH ROHS EXEMPT OR NON-COMPLIANT MATERIALS
- 3. COATING (APPLY ACROSS CLEAR APERTURE)
S1 & S2 : VIS-NIR
- 4. FINE GRIND SURFACE
- 5. POWER, IRREGULARITY, AND SURFACE QUALITY SPECIFICATIONS APPLY ACROSS CLEAR APERTURE
- 6. CHIPS OUTSIDE OF CLEAR APERTURE: <0.5
- 7. CLEAR APERTURE AND COATING APERTURE ARE CENTERED ON SURFACES

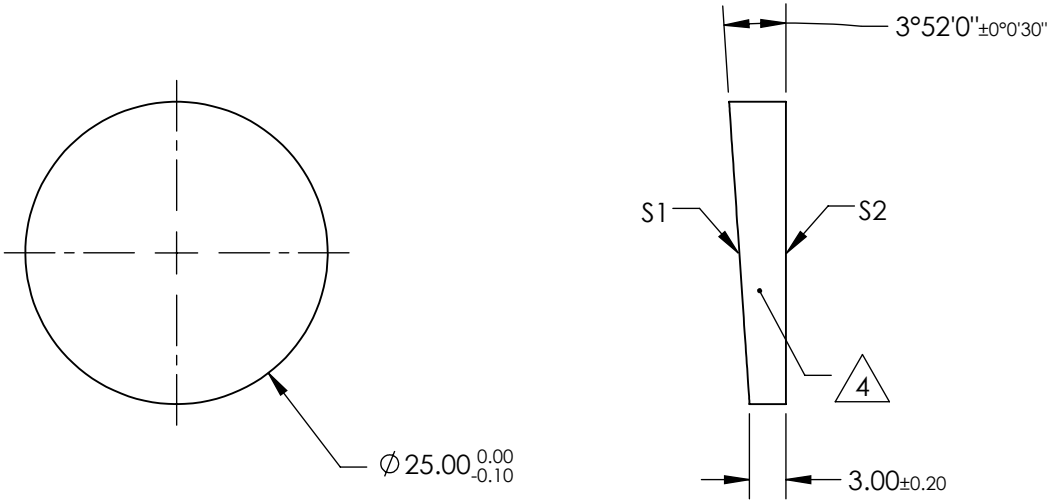

**FOR INFORMATION ONLY:
DO NOT MANUFACTURE
PARTS TO THIS DRAWING**

| | |
|-----------------------|----------------------|
| | S1 & S2 |
| SHAPE | PLANO |
| POWER (DIOPTERS) | 3.49 |
| ANGLE TOL. (ARCSEC) | ± 30 |
| SURFACE QUALITY | 20-10 |
| SURFACE FLATNESS | $\lambda/10$ |
| WAVELENGTH RANGE (nm) | 400 - 1000 |
| CLEAR APERTURE | $\varnothing 22.50$ |
| IMAGE ORIENTATION | BEAM DEVIATION |
| BEVEL | PROTECTIVE AS NEEDED |

SPECIFICATIONS SUBJECT TO CHANGE WITHOUT NOTICE
DIMENSIONS ARE FOR REFERENCE ONLY

Edmund Optics®



TITLE

2° NOM. VIS-NIR COATED, WEDGE PRISM

ALL DIMS IN

mm

DWG NO

45559

SHEET
1 OF 1