

NOTES:

1. SUBSTRATE MATERIAL:
FUSED SILICA
2. COATING (APPLY ACROSS CLEAR APERTURE)

S1 & S2: UV-AR

R(abs) $\leq 1.0\%$ @ 250 - 425nm
R(avg) $\leq 0.75\%$ @ 250 - 425 nm
R(avg) $\leq 0.5\%$ @ 370 - 420nm

3. WEDGE TOLERANCE: <15 arcmin

4. FINE GROUND SURFACE

5. POWER, IRREGULARITY, AND SURFACE QUALITY
SPECIFICAIONS APPLY ACROSS CLEAR APERTURE
6. RoHS COMPLIANT

**FOR INFORMATION ONLY:
DO NOT MANUFACTURE
PARTS TO THIS DRAWING**

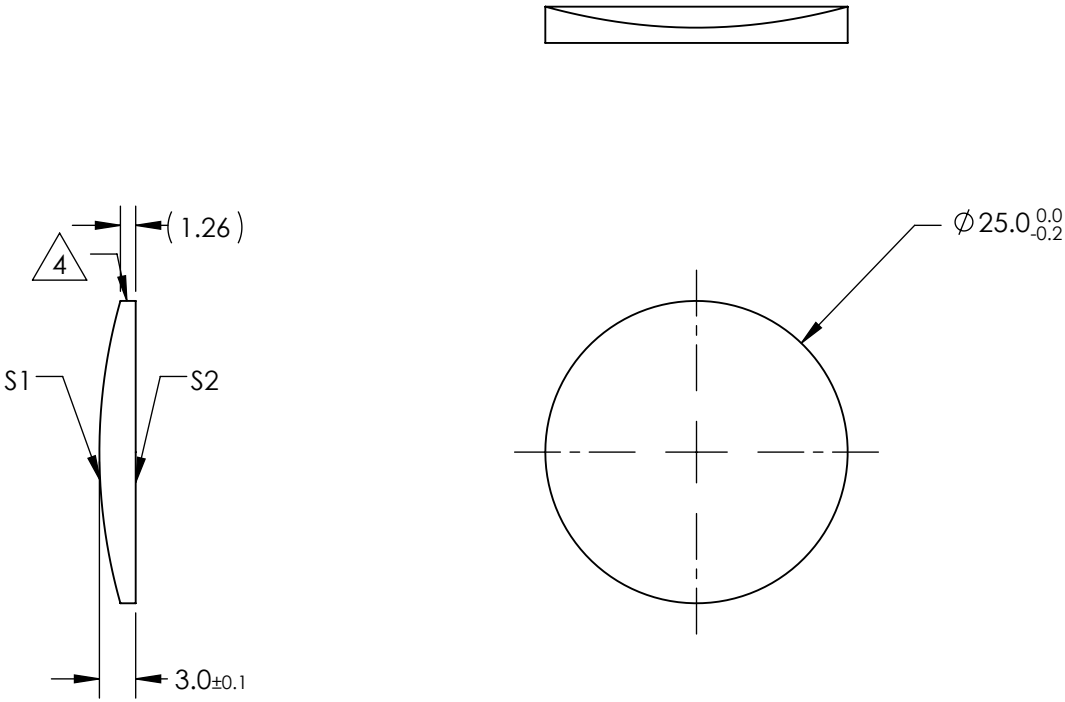

SPECIFICATIONS SUBJECT TO CHANGE WITHOUT NOTICE
DIMENSIONS ARE FOR REFERENCE ONLY

REV. A	S1	S2	<div><div><div></div><div></div></div><div>Edmund Optics®</div></div>						
SHAPE	CONVEX	PLANO						EFL	100
RADIUS	45.85	∞						BFL	97.94
SURFACE QUALITY	40-20	40-20	<div>THIRD ANGLE PROJECTION</div> <div><div></div><div></div></div>		TITLE	25mm DIAMETER X 100mm FL UV-AR COATED, UV PCX CYLINDER LENS			
CLEAR APERTURE	Ø24.00	Ø24.00							
COATING APERTURE	Ø24.00	Ø24.00							
BEVEL	PROTECTED AS NEEDED	PROTECTED AS NEEDED	ALL DIMS IN	mm	DWG NO	68182	SHEET 1 OF 1		