

NOTES:

1. SUBSTRATE
FUSED SILICA
2. SURFACE S2 TO BE PARALLEL TO SURFACE S1 TO WITHIN <3 ARCMIN
3. COATING (APPLY ACROSS COATING APERTURE):

S1: 532 HR Coating
R (ABS) > 99.80% @ 532nm @ 0-45° AOI

DAMAGE THRESHOLD,
PULSED: 10 J/cm², 20ns, 20Hz @ 532nm
CW: 1MW/cm² @ 532nm

S2: NONE

4. FINE GRIND SURFACE
5. POWER, IRREGULARITY, AND SURFACE QUALITY SPECIFICATIONS APPLY ACROSS CLEAR APERTURE
6. CLEAR APERTURE AND COATING APERTURE ARE CENTERED ON SURFACES
7. APPLY ARROW ON EDGE WITH LASER ETCH, PENCIL, OR PERMANENT INK POINTING TOWARDS SURFACE S1

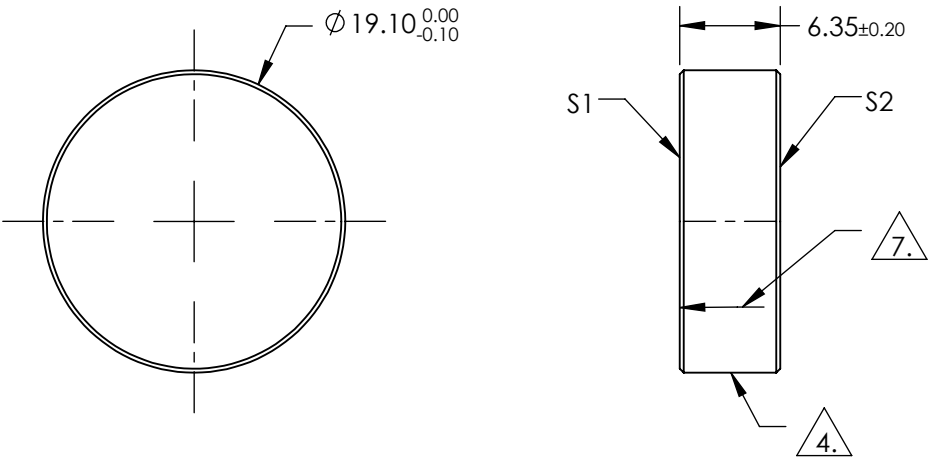

**FOR INFORMATION ONLY:
DO NOT MANUFACTURE
PARTS TO THIS DRAWING**

SPECIFICATIONS SUBJECT TO CHANGE WITHOUT NOTICE
DIMENSIONS ARE FOR REFERENCE ONLY

	S1	S2				
SHAPE	PLANO	PLANO	<div><div>THIRD ANGLE PROJECTION</div><div></div></div> <div>Edmund Optics®</div> <div>Ø19.1mm x 6.35mm, 532nm, NdYAG MIRROR 0-45° AOI</div>			
SURFACE QUALITY	10-5	COMMERCIAL POLISH				
SURFACE FLATNESS	0.10 WAVE	N/A				
MIN CLEAR APERTURE	Ø17.19	N/A				
MIN COATING APERTURE	Ø17.19	N/A				
BEVEL	PROTECTIVE AS NEEDED	PROTECTIVE AS NEEDED	ALL DIMS IN	mm	DWG NO	38892
					SHEET 1 OF 1	