

- NOTES:
- 1. SUBSTRATE:  
BLACK DIAMOND™ BD-2 (Ge28Sb12Se60)
  - 2. NUMERICAL APERTURE: 0.71
  - 3. COATING:  
R(AVG) <1.0% @ 1.8 - 3.0µm
  - 4. FOCAL LENGTH TOLERANCE: ±1%
  - 5. RoHS: COMPLIANT

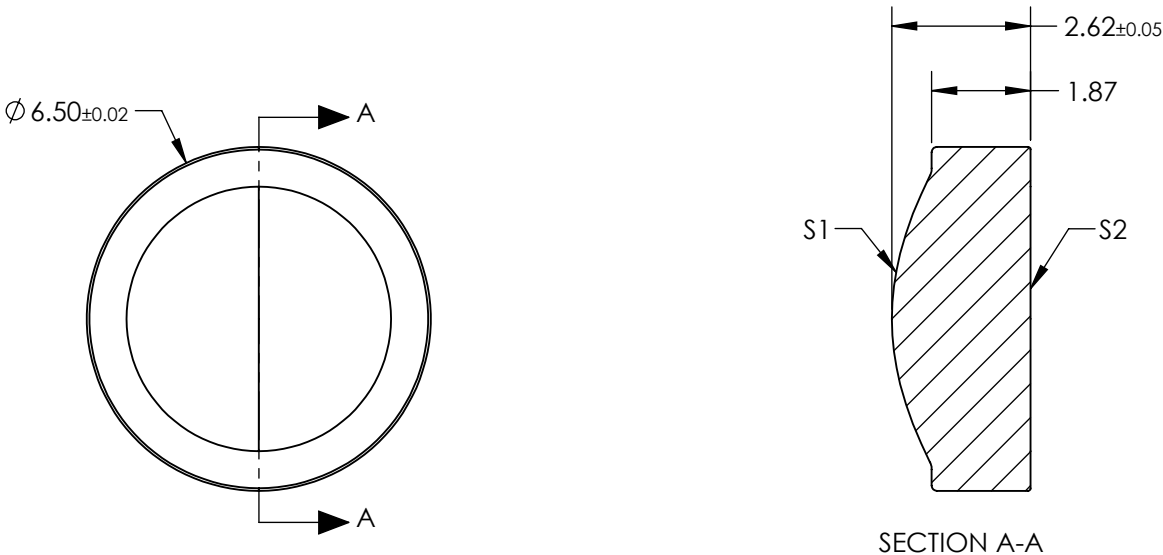

**FOR INFORMATION ONLY:  
DO NOT MANUFACTURE  
PARTS TO THIS DRAWING**

SPECIFICATIONS SUBJECT TO CHANGE WITHOUT NOTICE  
DIMENSIONS ARE FOR REFERENCE ONLY

	S1	S2
SHAPE	CONVEX	PLANO
SURFACE QUALITY	80-50	80-50
MIN CLEAR APERTURE	Ø5	Ø5
BEVEL MAX FACE	PROTECTIVE AS NEEDED	PROTECTIVE AS NEEDED

THIRD ANGLE  
PROJECTION

ALL DIMS IN      mm

**EO**® Edmund Optics®

TITLE	Infrared Asphere 0.71NA, 3mm FL, 1.8-3.0µm AR Coated		
DWG NO	88074		SHEET 1 OF 1