

NOTES:

- 1. MATERIAL:
BEAD-BLASTED ANODIZED ALUMINUM
- 2. INCLUDED HARWARE:
(2) 1/4-20, 1 1/2" LONG BHCS
(1) ENGLISH ALLEN WRENCH (#55-191)
- 3. ROHS: COMPLIANT

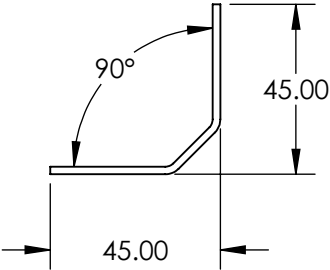
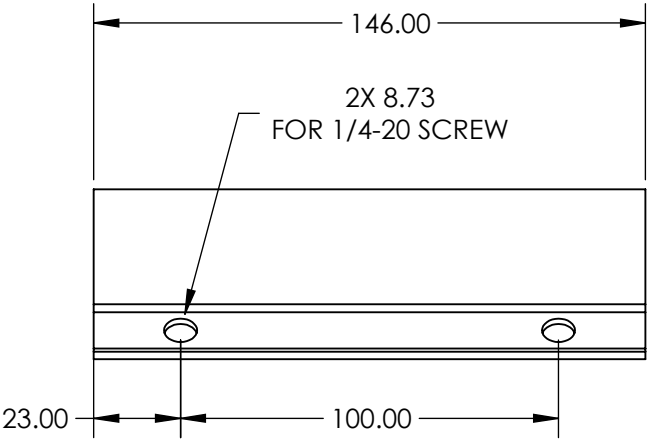

**FOR INFORMATION ONLY:
DO NOT MANUFACTURE
PARTS TO THIS DRAWING**

SPECIFICATIONS SUBJECT TO
CHANGE WITHOUT NOTICE
DIMENSIONS ARE FOR
REFERENCE ONLY

EO® Edmund Optics®

| | | | | |
|---------------------------|----|--------|---|-----------------|
| THIRD ANGLE PROJECTION | | TITLE | 6" CORNER JOINING PLATES FOR LASER SAFETY BARRIERS | |
| ALL DIMS IN | mm | DWG NO | 14735 | SHEET 1 OF 1 |