

- NOTES:
- 1. SUBSTRATE: Fused Silica (Corning 7980)
 - 2. COATING (APPLY ACROSS CLEAR APERTURE)

S1 & S2: R(ABS) <0.25% @ 532nm
R(ABS) <0.10% 1064nm

DAMAGE threshold, pulsed:
5 J/cm² @ 532nm, 20ns, 20Hz
15 J/cm² @ 1064nm, 20ns, 20Hz
 - 3. FINE GRIND SURFACE
 - 4. ROHS COMPLIANT

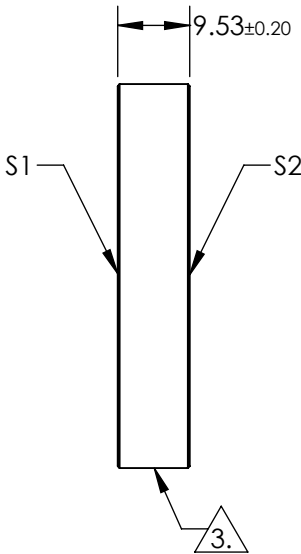
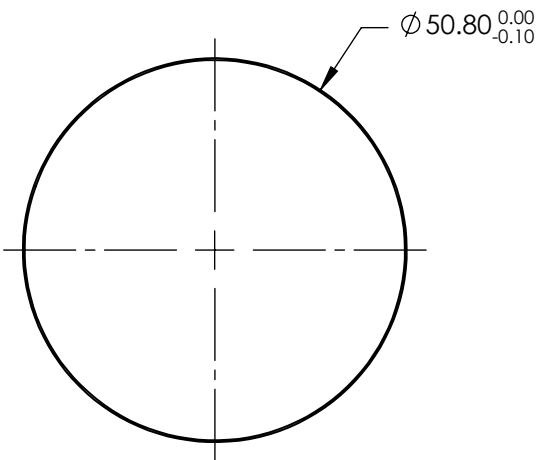
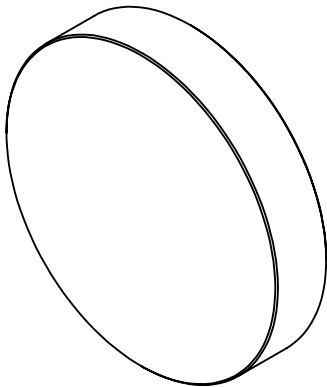

**FOR INFORMATION ONLY:
DO NOT MANUFACTURE
PARTS TO THIS DRAWING**

SPECIFICATIONS SUBJECT TO CHANGE WITHOUT NOTICE
DIMENSIONS ARE FOR REFERENCE ONLY

REV. A	S1	S2
SHAPE	PLANO	PLANO
SURFACE FLATNESS	$\lambda/10$	$\lambda/10$
SURFACE QUALITY	10-5	10-5
CLEAR APERTURE	$\phi 45.72$	$\phi 45.72$
BEVEL	PROTECTED AS NEEDED	PROTECTED AS NEEDED



ALL DIMS IN

mm

Edmund Optics®

TITLE

532, 1064nm, 50.8mm, DUAL-BAND AR FUSED
SILICA WINDOW

DWG NO

17589

SHEET
1 OF 1