

NOTES:

- 1. SUBSTRATE:  
FUSED SILICA
- 2. ROHS COMPLIANT
- 3. COATING (APPLY ACROSS CLEAR APERTURE)

S1 & S2: 1064 V-COAT  
R(ABS) <0.25% @ 1064nm

4. FINE GRIND SURFACE (ADD INK NOTE AS NEEDED)

5. FINE GRIND SURFACE

6. FOCAL LENGTH (EFL): -9.00 mm  
BACK FOCAL LENGTH (BFL): -10.38 mm

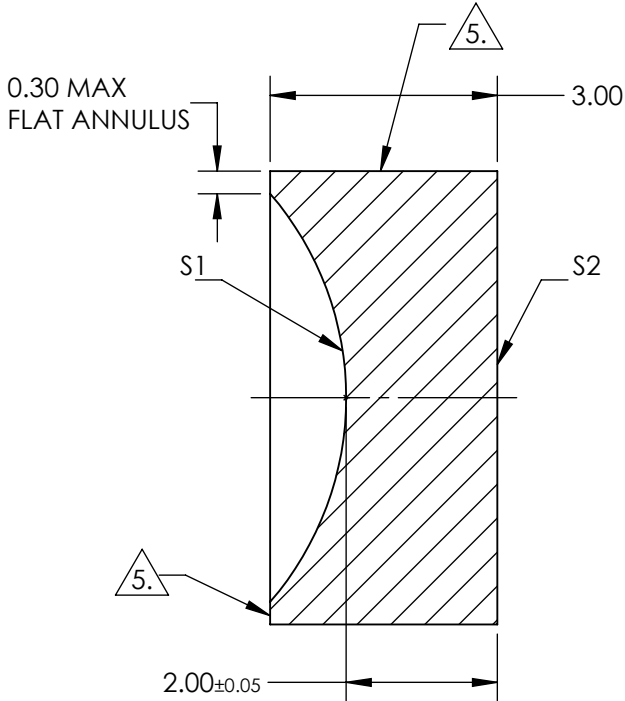
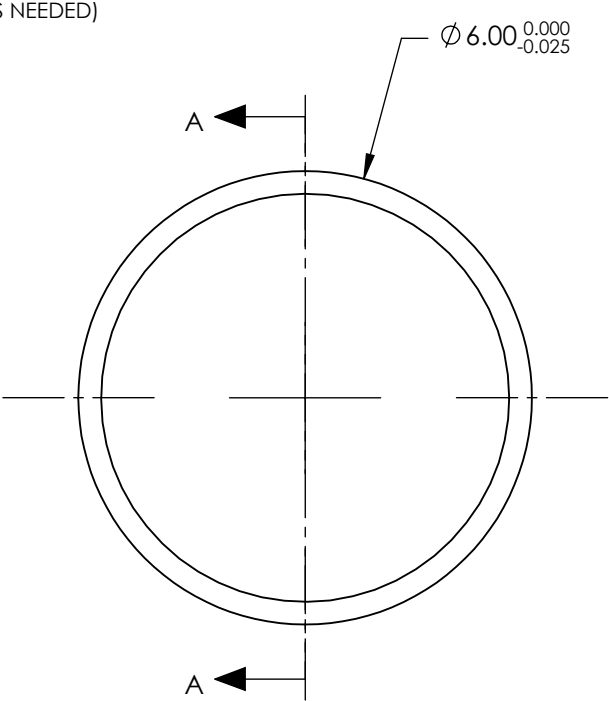

SECTION A-A

**FOR INFORMATION ONLY:  
DO NOT MANUFACTURE  
PARTS TO THIS DRAWING**

SPECIFICATIONS SUBJECT TO CHANGE WITHOUT NOTICE  
DIMENSIONS ARE FOR REFERENCE ONLY

	S1	S2
SHAPE	CONCAVE	PLANO
RADIUS	-4.13	INFINITY
SURFACE QUALITY	40-20	40-20
CLEAR APERTURE	Ø 5.4	Ø 5.4
BEVEL	PROTECTED AS NEEDED	PROTECTED AS NEEDED

THIRD ANGLE  
PROJECTION

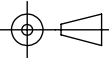

ALL DIMS IN

mm



Edmund Optics®

TITLE

6.0mm Dia. x -9 FL, 1064 V-Coat, UV Plano-  
Concave Lens

DWG NO

21026

SHEET  
1 OF 1