

NOTES:

1. SUBSTRATE:  
FUSED SILICA
2. ROHS COMPLIANT

3. COATING (APPLY ACROSS CLEAR APERTURE)

S1 & S2: VIS-NIR (400-1000nm)  
R(ABS)  $\leq 0.25\%$  @ 880nm  
R(AVG)  $\leq 1.25\%$  @ 400 - 870nm  
R(AVG)  $\leq 1.25\%$  @ 890 - 1000nm

4. FINE GRIND SURFACE (ADD INK NOTE AS NEEDED)

5. FINE GRIND SURFACE

6. FOCAL LENGTH (EFL): -30mm  
BACK FOCAL LENGTH (BFL): -31.37mm

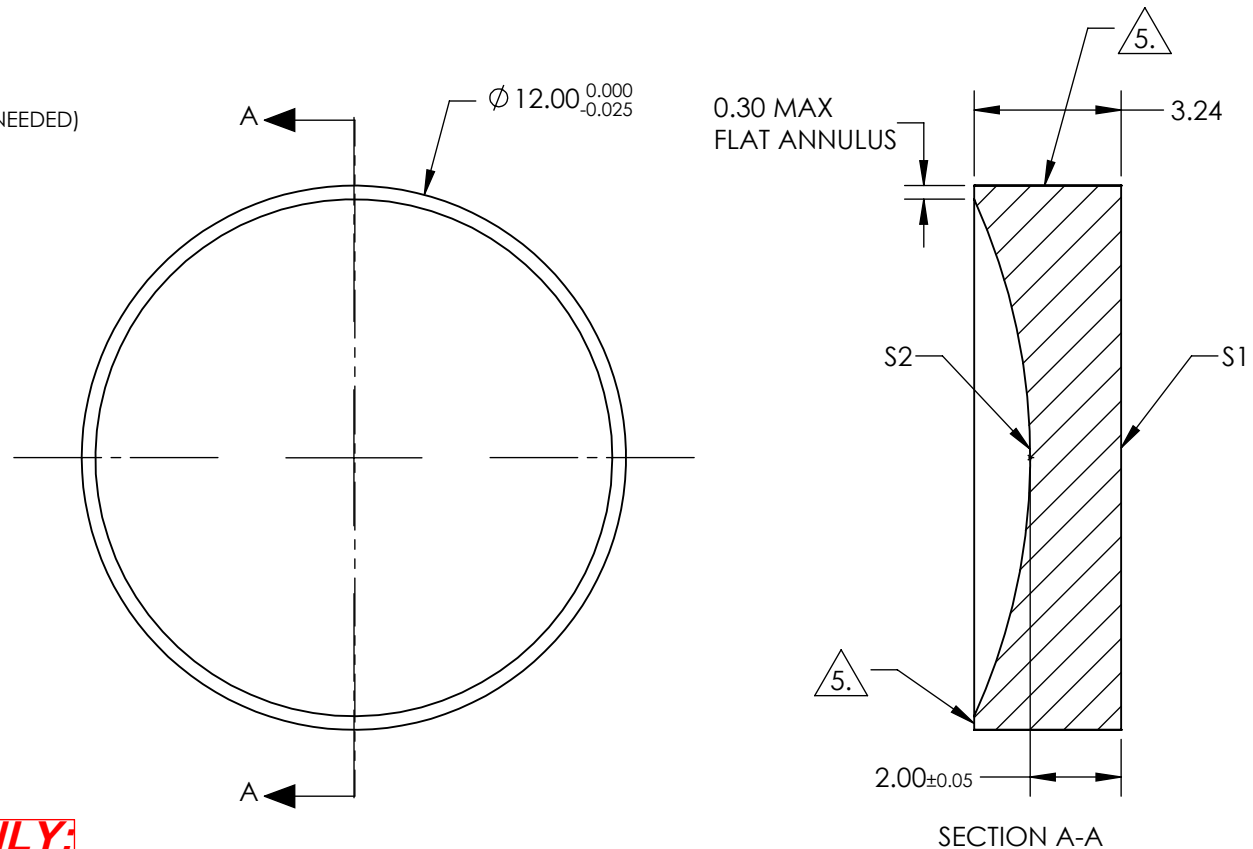

**FOR INFORMATION ONLY:  
DO NOT MANUFACTURE  
PARTS TO THIS DRAWING**

SPECIFICATIONS SUBJECT TO CHANGE WITHOUT NOTICE  
DIMENSIONS ARE FOR REFERENCE ONLY

	S1	S2
SHAPE	CONCAVE	PLANO
RADIUS	-13.75	INFINITY
SURFACE QUALITY	40-20	40-20
CLEAR APERTURE	$\varnothing 11$	$\varnothing 11$
BEVEL	PROTECTED AS NEEDED	PROTECTED AS NEEDED



ALL DIMS IN

mm

**EO<sup>®</sup> Edmund Optics<sup>®</sup>**

TITLE

12.0mm Dia. x -30 FL, VIS-NIR, UV Plano-Concave Lens

DWG NO

21050

SHEET  
1 OF 1