

NOTES:

1. SUBSTRATE:
FUSED SILICA

2. COATING (APPLY ACROSS CLEAR APERTURE)

S1: Ultrafast (1260 - 1360nm)

R(avg) S & P > 99.90% @ 1310nm @ 45° AOI

R(avg) > 99.7% @ 1260 - 1360nm @ 45° AOI

GDD SPECIFICATION:

GDDs: ± 20 fs² @ 1260 - 1360nm @ 45° AOI

GDDp: ± 30 fs² @ 1285 - 1335 nm @ 45° AOI

S2: NONE

3. FINE GRIND SURFACE

4. ROHS COMPLIANT

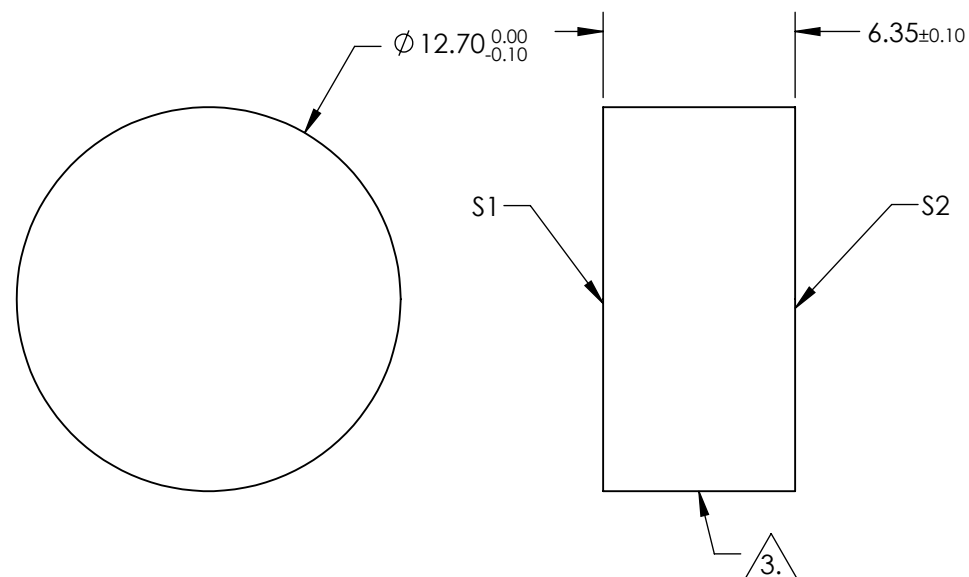
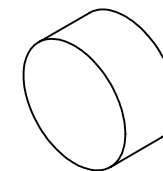

**FOR INFORMATION ONLY:
DO NOT MANUFACTURE
PARTS TO THIS DRAWING**

SPECIFICATIONS SUBJECT TO CHANGE WITHOUT NOTICE
DIMENSIONS ARE FOR REFERENCE ONLY

	S1	S2
SHAPE	PLANO	PLANO
SURFACE QUALITY	10 - 5	COMMERCIAL POLISH
CLEAR APERTURE	Ø 11.43	N/A
SURFACE FLATNESS	$\lambda/8$	N/A
BEVEL	PROTECTED AS NEEDED	PROTECTED AS NEEDED



ALL DIMS IN mm

EO® Edmund Optics®

TITLE

1310nm, 12.7mm Dia. x 6.35mm Thickness,
Ultrafast Laser Mirror

DWG NO

28995

SHEET
54 OF 86