

NOTES:  
1. SUBSTRATE:  
EAGLE XG®

2. COATING (APPLY ACROSS CLEAR APERTURE)  
S1 & S2: NONE

3. GROUND AND SEAMED

4. ROHS COMPLIANT

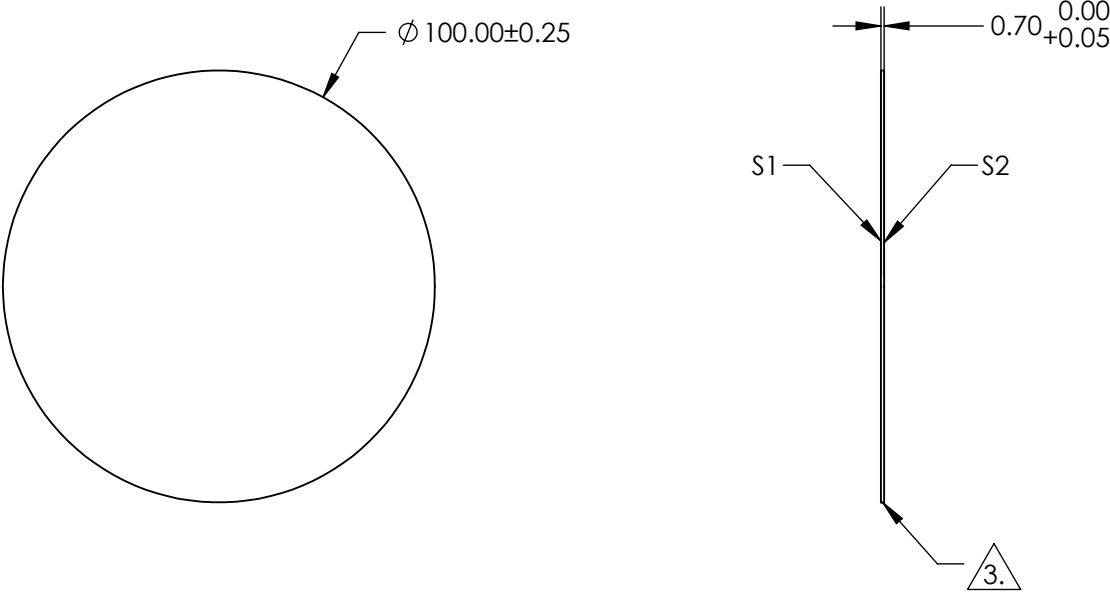
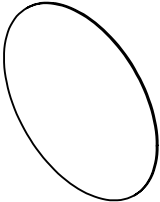

**FOR INFORMATION ONLY:  
DO NOT MANUFACTURE  
PARTS TO THIS DRAWING**

SPECIFICATIONS SUBJECT TO CHANGE WITHOUT NOTICE  
DIMENSIONS ARE FOR REFERENCE ONLY

**EO**® Edmund Optics®

|                 | S1                  | S2                  |
|-----------------|---------------------|---------------------|
| SHAPE           | PLANO               | PLANO               |
| SURFACE QUALITY | 80 - 50             | 80 - 50             |
| CLEAR APERTURE  | Ø 90.00             | Ø 90.00             |
| BEVEL           | PROTECTED AS NEEDED | PROTECTED AS NEEDED |



THIRD ANGLE  
PROJECTION

ALL DIMS IN

mm

TITLE

100mm Dia., 0.7mm Thick, EAGLE XG®  
Window

DWG NO

29371

SHEET  
12 OF 12